

WINGET

OPERATING MANUAL & PARTS LIST 2T MIXER



WINGET LIMITED
PO BOX 41
EDGEFOLD INDUSTRIAL ESTATE
PLODDER LANE
BOLTON, U.K.
BL4 0LR
TEL + 44 (0) 1204 854650
FAX + 44 (0) 1204 854663
parts@winget.co.uk
service@winget.co.uk
www.winget.co.uk

WINGET

2T TILTING

MIXER



This manual is a reprint of the Winget publication printed during July 1964 and is a direct copy of one of the remaining original manuals.

Winget Limited have always operated a policy of continuous product development. Therefore, some illustrations or text within this publication may differ from your machine. The contents of this manual although correct at the time of publication in July 1964, may have been subject to alteration by the manufacturers in the intervening years without notice and Winget Limited can accept no responsibility for any errors or omissions contained within the following pages. Nor can we accept any liability whatsoever arising from the use of this manual howsoever caused.

**General Operating and
Maintenance Instructions
and Spare Parts List**

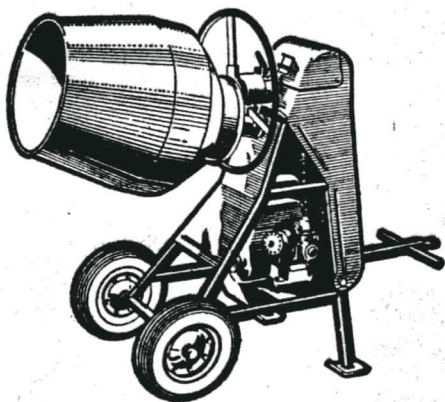

**Winget
2-T
CONCRETE MIXER**

(3/2 cu ft capacity)

Operating and Maintenance Instructions

To retain the maximum efficiency of your 2T mixer it is essential that the following maintenance instructions be regularly carried out.

GENERAL MAINTENANCE

Keep the mixer clean. A wash down after use will reduce considerably the ultimate wear.

LUBRICATION

Four grease nipples or stauffers will be found on the Tilting mechanism and drive unit. These feed the main running parts by means of drilled shafts and special greaseways. Lubricate with a medium grease, cleaning the nipples before and after use. Three or four strokes of the gun every week will ensure maximum life of the bearings and other moving parts. Roadwheel bearings should be greased periodically.

Apply a little engine oil from time to time to the pin—item 10, on the tilting handwheel locking lever.

TRANSMISSION

Give the driving chain a few drops of oil now and again.

Adjustment of the chain is seldom required, but may be obtained by removing packing washers—item 47—on which the engine stands. It is preferable to run with the transmission too slack than too tight as undue tightness will put excessive strain on the engine shaft causing vibrating and considerable wear.

ENGINE

Study carefully the instruction booklet issued by the engine manufacturers.

Carry out their instructions.

Check the oil level in the sump daily. Do not overfill.

Ample ventilation for the engine is provided with the housing in position. Do not remove it.

MIXING DRUM

To get the best out of your mixer keep the drum clean internally. Wash it out when finished and leave it tilted in the discharge position.

GENERAL POINTS

Check for tightness from time to time—and especially during the first few weeks—all nuts, bolts, keys, etc. Particular attention should be paid to the fixing bolts of the drum, the engine, and Trunnion bearing.

SPARE PARTS AND SERVICE

Spares are seldom required but when they are, always state the type and number of the machine. (This can be obtained from the name plate.)

A detailed list is included in this booklet and the description of the part, together with the part number must be given in each case. For fuller details see back pages.

Do not remove or strip any parts unless absolutely necessary. Remember that you have a Winget Service Depot near you which is always ready and willing to help.

SPECIAL NOTE

The parts illustrated in this list cover machines up to and including 2TA/1452.

All mixers with higher numbers are built *without* detachable feet (Part No. 50) and detachable drip ring (Part No. 35A).

In addition the roadwheels are now fitted with 14 in. × 3 in. cushion tyres instead of pneumatic (Part No. 49).

Spare Parts List

REF. NO.	NO. PER MACHINE	DESCRIPTION OF PART	PART NO.
1	1	Bevel pinion shaft	N19359
2			—
3	1	Locking pin	PC410/12
4	1	Chain wheel	N19355
5	1	Thrust washer	—
6	1	Trunnion bearing	N19356
7	4	Grease nipples	ND102/G
8	1	Trunnion	N19351
9	1	Locking lever	N19604
10	1	Locking lever pin	PC410/12
11	1	Handwheel	N19357
12	3	Handwheel fixing bolts	WB106/8
13	1	Bevel gear locking pin	—
14	1	Bevel gear	N19365
15	1	Thrust washer B.G. end	N19363
16	1	Washer	N19362
17	2	Shell bearings	B0201
18	1	Drum shaft	N19358
19	2	Drum shaft ball race	BJ440
20	1	Drum shaft locking pin	PC512/20
21	1	Bevel gear ring	N19353
22	1	Bevel gear ring guard (in halves)	N19354
23	2	Guard fixing bolts	SS406/4
24	1	Guard fixing bolt	WB204/4
25	1	Distance tube	N19361
26*	1	Stop for trunnion	N29148
27	2	Cap fixing setscrews	SS406/8

* Not illustrated.

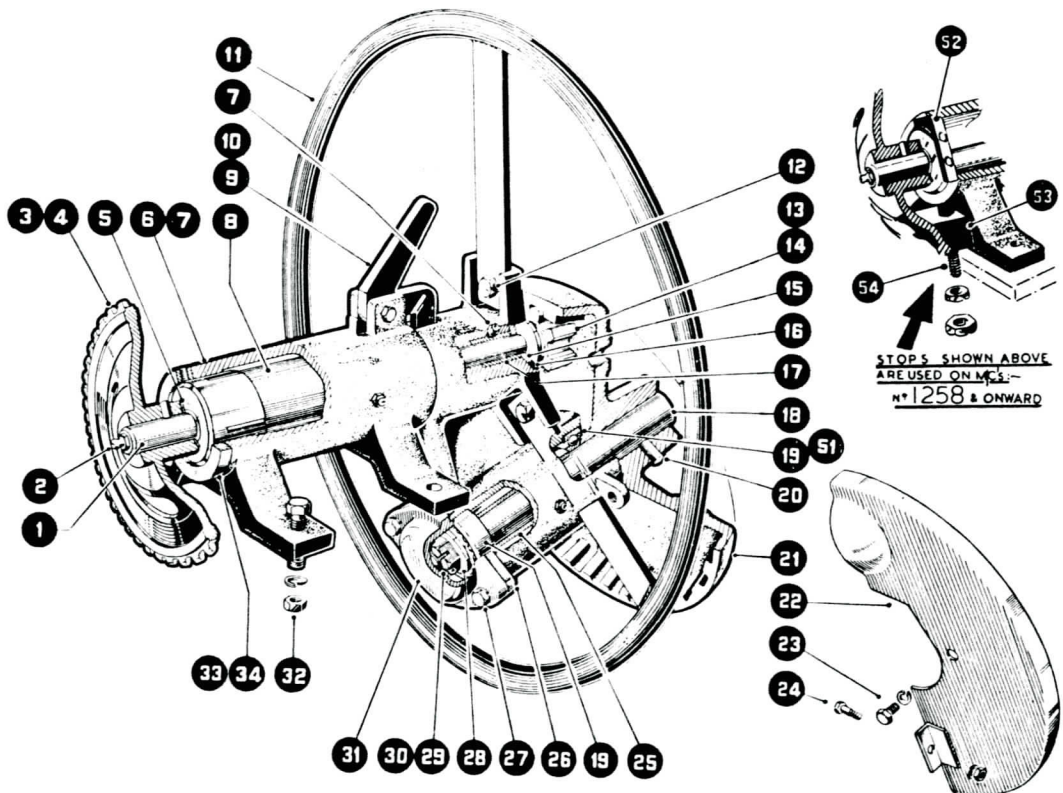

Spare Parts List

REF. NO.	NO. PER MACHINE	DESCRIPTION OF PART	PART NO.
28	1	Retaining washer	—
29	1	Drum shaft nut	NB510
30	1	Split pin	PD304/14
31	1	Cap for housing	N19360
32	4	Trunnion bearing attachment bolts	WB108/12
33	1	Collar	N19364
34	2	Screws for collar	SD505/8
35	1	Drum and (35A* Drip Ring - N 271330	N19377
36	2	Drum blades	N19608
37	4	Drum blade fixing bolts	SC305/6
38	6	Drum attachment bolts	WB106/12
39	1	Frame	N19571
40	1	Villiers MK 10 engine	—
41	1	Engine sprocket	N19366
42	1	Engine chain	CC104/112
43	1	Engine housing	N19572
44	1	Tool box cover	N19572/4
45	1	Tow bar	N19571/5
46	1	Pin	N19571/16
47	as reqd.	Engine packing washers	—
48	4	Engine bolts	WA306/14
49	2	Pneumatic road wheels	WP116/4
	*2	Cushion Type Road Wheels	WP413/3/N
50	2	Legs and pins	N19571/20
51	1	Fibre washer	N25255
52	1	Trunnion stop (complete with $\frac{3}{8}$ -in. Whit Allen type bolts)	N29148
53	1	Stop on top frame	N29165
54	1	Allen setscrew (complete with nut and locknut)	—

*Not illustrated.

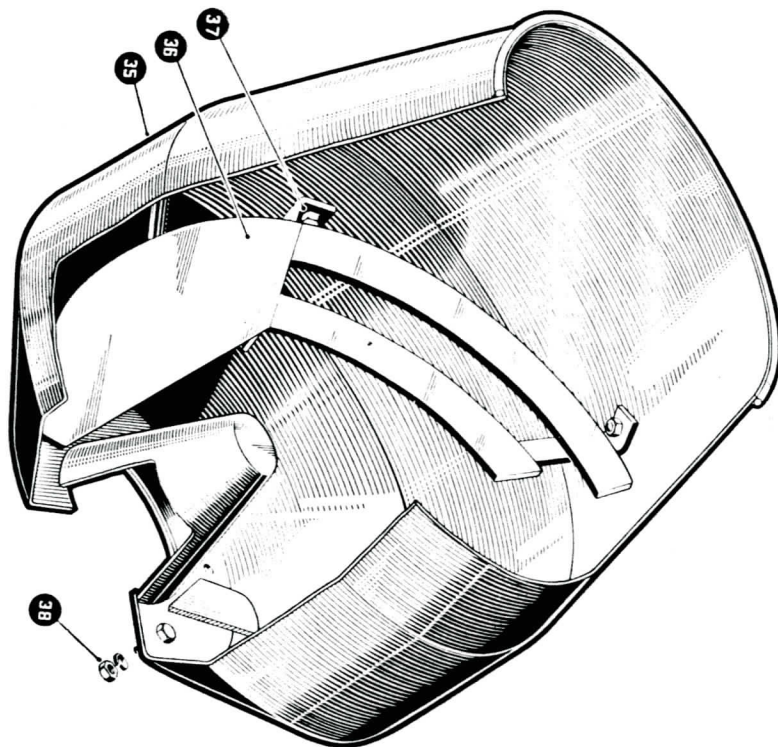

REF. NO.	NO. PER MACHINE	DESCRIPTION OF PART	PART NO.
55*	1	Bevel pinion	N29015
56*	1	Bevel gear ring	N31489
57*	1	Bevel gear ring guard	N29042
58*	1	Thrust washer B.C. end	N19363
Parts applicable to 2T Mixer fitted with 1-2 h.p. Jap 2S Petrol Engine			
59*	1	JAP 2S petrol engine	—
60*	1	Engine sprocket	N28735
61*	1	Engine chain	CE104/122
62*	1	Chainguard	N29309

* Not illustrated.

How to order spares

FOR FITTING IN YOUR OWN WORKSHOP

FROM YOUR NEAREST DEPOT

This is the best and quickest method of obtaining spare parts. Seven main Winget Depots and thirty-four Service Agents cover the country to give easier access to spares together with cheaper and more efficient service. The nearest spare is the cheapest.

To avoid delays and errors, remember always to quote:—

THE MACHINE NUMBER

which will be found stamped on a cast plate. This is the plate

The number we want appears here:—

WINGET LIMITED			
ROCHESTER KENT ENGLAND			
[]			
WHEN ORDERING SPARES QUOTE MACHINE NO. []			
1. SIZE OF MIXER	[]	4. YEAR OF MANUFACTURE	[]
2. RPM OF MIXING DRUM	[]	5. PATENT NUMBER	[]
3. RPM OF COUNTER SHAFT	[]	6. WEIGHT	[]
THIS MACHINE IS BUILT TO BRITISH STANDARD SPECIFICATION NO. 1905		CWTS	[]
		QNS	[]

DESCRIPTION OF PART AND PART NUMBER

exactly as listed in this booklet

give engine make and number, also mixer number

IF ENGINE SPARES ARE REQUIRED

IF YOU DO NOT KNOW YOUR NEAREST DEPOT telephone your nearest permanent Winget Main Depot where they will be pleased to give you every assistance. A full list of names and addresses is given in this publication.

DIRECT FROM ROCHESTER WORKS

In case of difficulty, spares may be obtained direct from Works at Rochester. The same information will be required, but if you telephone or telegraph, an official confirmation order must be sent by post immediately.

Ring Strood, Kent 78641 (8 lines) and ask for Spares Department. Weekdays from 8.15 a.m. to 6 p.m. and on Saturdays until 12 noon.

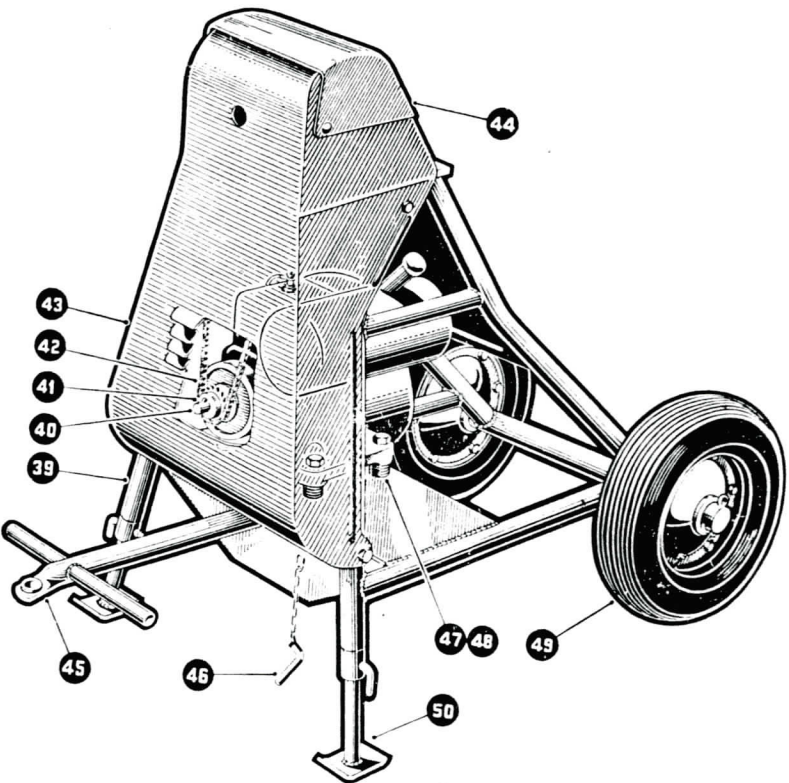

How to get Service

THE WINGET WATCHDOG SERVICE

Operating through every Winget Depot and Service Agent is THE WINGET WATCHDOG SERVICE giving a comprehensive service cover over the entire country. A call to your service depot will bring swift assistance to get your plant earning profit again in the shortest possible time. Be sure to give the fullest details of the machine and the nature of the breakdown.

LIST OF WINGET MAIN DEPOTS

SOUTHERN

EXETER (Devon)
Plant Engineering Services (Exeter) Ltd.,
Haven Road, Exeter.
Tel: Exeter 77730

LYVBRIDGE (Devon)
Plant Engineering Services (Exeter) Ltd.,
Costly Street, Lyvbridge.
Tel: Lyvbridge 34516

LONDON AREA

Moore's Plant Ltd.,
105/109 Markfield Road,
Tottenham, N.15
Tel: Tottenham 0401

ROCHESTER (Kent)
Winget Ltd., Rochester.
Tel: Strood 78641

MIDLANDS

NOTTINGHAM (Nottinghamshire)
Winget Ltd.,
Ouse Bridge Drive,
Carlton, Nottingham.
Tel: Nottingham 247014

ALTRINGHAM (Cheshire)
Winget Ltd.,
Vindicta Road, Broadbeath,
Altrincham
Tel: Altrincham 4214.

SCOTLAND

COATBRIDGE (Lanarkshire)
Winget Ltd.,
Rosehall Works,
Coatbridge, Lanarkshire.
Tel: Coatbridge 1232/3

Winget

WINGET LTD., ROCHESTER, KENT, ENGLAND

Telephone: Strood, Kent 78641 (8 lines) Telex: 89149

Telegrams: Wingetiam, Rochester (Telex)

London Office: 1-5 New Bond Street, London, W.1

Telephone: HYDe Park 0721-2-3

Telegrams: Wingetism, Phone, London

PLEASE NOTE CHANGE OF
TELEPHONE No. MEDWAY 7777
TELEX No. 96149